

THIS COPY IS PROVIDED ON A RESTRICTED BASIS AND IS NOT TO BE USED IN ANY WAY DETRIMENTAL TO THE INTERESTS OF PANDUIT CORP.

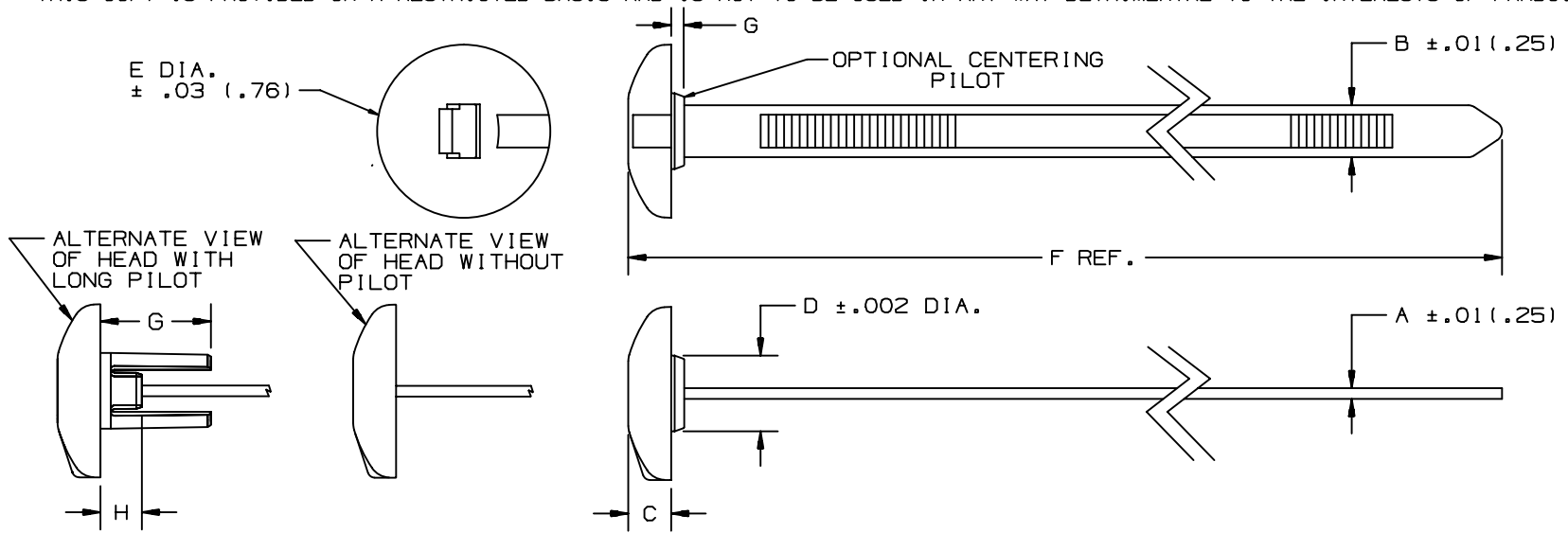

| PANDUIT * PART NO. | BUNDLE DIA. | | A in (mm) | B in (mm) | C in (mm) | D in (mm) | E in (mm) | F in (mm) | G in (mm) | H in (mm) | RECOMMENDED HOLE SIZE RANGE | MIN. LOOP TENSILE lbs (N) | CROSS SECTION | WEIGHT 50 pcs lbs (g) |
|-----------------------|-----------------|-----------------|---------------|---------------|---------------|----------------|---------------|---------------|---------------|---------------|-----------------------------------|------------------------------------|------------------|-----------------------------|
| | MIN. in (mm) | MAX. in (mm) | | | | | | | | | | | | |
| SSPM2.5H | .06 (1.5) | 2.76 (70) | .062 (1.6) | .300 (7.6) | .248 (6.3) | — | 1.0 (25.4) | 10.1 (257) | — | — | .316 to .820 (8.0 to 21) | 120 (534) | HEAVY | .519 (235) |
| SSPM2.5HP | .06 (1.5) | 2.76 (70) | .062 (1.6) | .300 (7.6) | .248 (6.3) | .437 (11.1) | 1.0 (25.4) | 10.1 (257) | .075 (1.9) | — | .440 to .820 (11.2 to 21) | 120 (534) | HEAVY | .526 (239) |
| SSPM4H | .06 (1.5) | 4.0 (102) | .062 (1.6) | .300 (7.6) | .248 (6.3) | — | 1.0 (25.4) | 14.8 (376) | — | — | .316 to .820 (8.0 to 21) | 120 (534) | HEAVY | .685 (311) |
| SSPM4HP | .06 (1.5) | 4.0 (102) | .062 (1.6) | .300 (7.6) | .248 (6.3) | .437 (11.1) | 1.0 (25.4) | 14.8 (376) | .075 (1.9) | — | .440 to .820 (11.2 to 21) | 120 (534) | HEAVY | .691 (313) |
| SSPM4HLP | .06 (1.5) | 4.0 (102) | .062 (1.6) | .300 (7.6) | .248 (6.3) | .437 (11.1) | 1.0 (25.4) | 14.8 (376) | .630 (16) | .236 (6.0) | .440 to .820 (11.2 to 21) | 120 (534) | HEAVY | .722 (327) |

NOTE: *1) SEE CURRENT PRICE SHEET FOR PART NUMBER SUFFIX DESIGNATION FOR PACKAGE SIZE AND PART COLOR.

CAD FILENAME/LAYERS

DIMENSIONS IN PARENTHESES ARE IN METRIC UNITS

SS-26346_00.PRT

PANDUIT CORP. TINLEY PARK, ILLINOIS

SSPM STA-STRAP® PANEL MOUNT
CABLE TIE

UNLESS OTHERWISE SPECIFIED,
DIMENSIONAL TOLERANCES ARE:
(.X) ± .1(.25) (.XXX) ± .020(.51)
(.XX) ± .02(.5) ANGLES ± -----

UNLESS OTHERWISE SPECIFIED,
ALL DIMENSIONS ARE GIVEN
IN INCHES, THIRD ANGLE PROJECTION.

DRAWN BY
FKS

MAT'L:

SCALE
NONE

7 1/30/04 JABO

CHANGED FORMAT FOR CONSISTENCY
SEE ECN FOR DETAILS

26346 7

DATE
3-27-91

NYLON 6/6

DRAWING NO.
SS-26346

DWG
A

NYLON 12

SIZE

| REV | DATE | BY | CHK | DESCRIPTION | ECN | R | CUST | SUP |
|-----|---------|------|-----|---|-------|---|------|-----|
| 7 | 1/30/04 | JABO | | CHANGED FORMAT FOR CONSISTENCY SEE ECN FOR DETAILS | 26346 | 7 | | |