

REVISIONS				
SYM	ZONE	ECN, ERN NO.	DATE	APPRD.
A		PROPOSAL	09/23/05	LCHAN

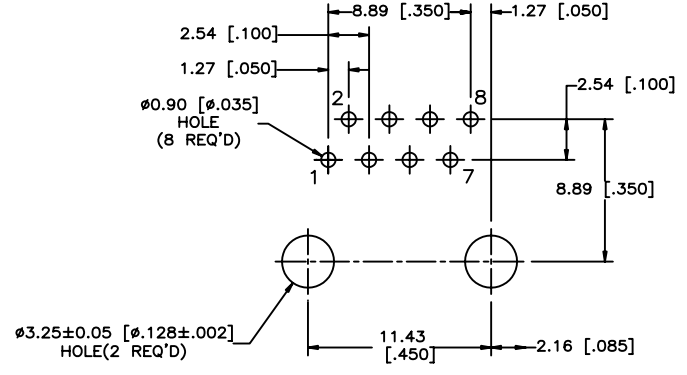

RECOMMENDED P.C.B. LAYOUT  
(COMPONENT SIDE OF BOARD)

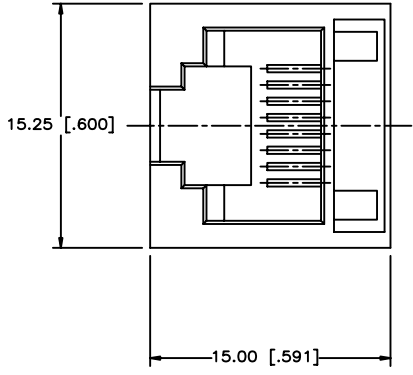
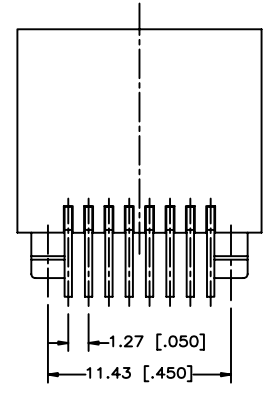
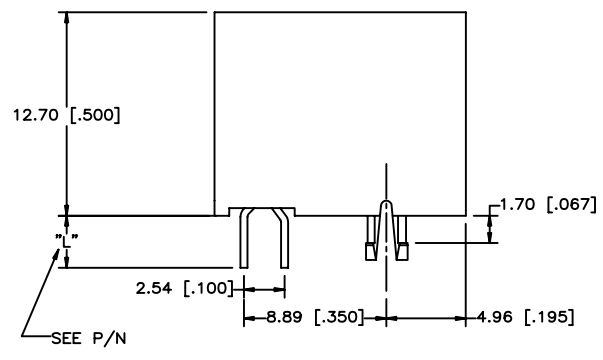

AMPHENOL PART NUMBER: R J E 0 6 - 1 8 8 - 0 X 1 X

- 0 STANDARD TAIL LENGTH :3.25mm
- 1 TAIL LENGTH :4.00mm
- 1 = WITHOUT FLANGE

SERIES R J E 0 6

1 PORT 1

NO. OF POSITIONS 8

NO. OF CONTACTS 8

GOLD PLATING

- 1 = 6 MICRO"
- 2 = 15 MICRO"
- 3 = 30 MICRO"
- 4 = 50 MICRO"
- NON-SHIELD

MATERIALS:

**HOUSING:** HIGH TEMP. THERMOPLASTIC  
FLAMMABILITY RATING UL94V-0  
COLOR:BLACK

**CONTACTS:** PHOSPHOR BRONZE  
GOLD PLATING (PER P/N TABLE)  
OVER NICKEL,  
MATTE TIN PLATING TAILS

**SHIELD:** COPPER ALLOY WITH NICKEL PLATED

THIS DOCUMENT CONTAINS PROPRIETARY INFORMATION AND SUCH INFORMATION MAY NOT BE DISCLOSED TO OTHERS FOR ANY PURPOSE OR USED FOR MANUFACTURING PURPOSES WITHOUT WRITTEN PERMISSION FROM AMPHENOL CANADA CORP.

DRAWN Chigow	DATE 09/23/05	Amphenol Canada Corp.			
DESIGNED					
CHECKED P. WANG	09/23/05				
I. E. APPRD.					
Q. A. APPRD.		TITLE	RJE06 SERIES, 8 POSITION 8 CONTACT, VERTICAL MOUNT, NON-SHIELD, RoHS COMPLIANT		
DWG. APPRD.		DWG	DRAWING NO.	P-RJE06-188-0X1X	
ENG. REL. NO.		REF.		REV.	A
DIMENSIONS ARE IN MM [inches]	CODE ID. NO. 03554	SCALE	WT.	SURF.	SHEET 1 OF 1