

PCB terminal block - IDC 0,3/ 6-3,81 - 1706219

Please be informed that the data shown in this PDF Document is generated from our Online Catalog. Please find the complete data in the user's documentation. Our General Terms of Use for Downloads are valid (<http://download.phoenixcontact.com>)

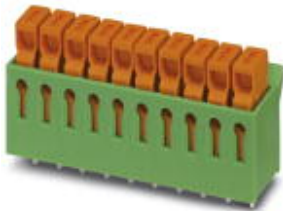

PCB terminal block, Nominal current: 5 A, Nom. voltage: 160 V, Pitch: 3.81 mm, Number of positions: 6, Connection method: Insulation displacement connection QUICKON, Mounting: Soldering, Conductor/PCB connection direction: 0 °, Color: green

The figure shows a 10-position version of the product

Why buy this product

- The IDC range is suitable for cables with PVC and PE insulation
- Tool-free connection of insulated conductors in a short assembly time
- PCB terminal block with fast insulation displacement connection technology and 3.81 mm pitch
- With a limit frequency of over 100 MHz, the IDC range meets the quality requirements of CAT5 according to EN 50173 and ISO/IEC 11801



Key commercial data

| | |
|------------------------|---|
| Packing unit | 1 |
| Minimum order quantity | 50 |
| Catalog page | Page 146 (CC-2011) |
| GTIN |  4 017918 116712 |
| Custom tariff number | 85369010 |
| Country of origin | POLAND |

Technical data

Dimensions / positions

| | |
|---------------------|------------|
| Length | 10 mm |
| Pitch | 3.81 mm |
| Dimension a | 19.05 mm |
| Number of positions | 6 |
| Pin dimensions | 1 x 0,4 mm |
| Hole diameter | 1.3 mm |

Technical data

| | |
|---------------------------|---------|
| Range of articles | IDC 0,3 |
| Insulating material group | I |

PCB terminal block - IDC 0,3/ 6-3,81 - 1706219

Technical data

Technical data

| | |
|---|---|
| Rated surge voltage (III/3) | 2.5 kV |
| Rated surge voltage (III/2) | 2.5 kV |
| Rated surge voltage (II/2) | 2.5 kV |
| Rated voltage (III/3) | 160 V |
| Rated voltage (III/2) | 160 V |
| Rated voltage (II/2) | 320 V |
| Connection in acc. with standard | EN-VDE |
| Nominal current I _N | 5 A |
| Nominal cross section | 0.34 mm ² |
| Maximum load current | 5 A (with 0.34 mm ² conductor cross section) |
| Insulating material | PA |
| Inflammability class according to UL 94 | V0 |
| Nominal voltage, UL/CUL Use Group B | 250 V |
| Nominal current, UL/CUL Use Group B | 5 A |
| Nominal voltage, UL/CUL Use Group D | 300 V |
| Nominal current, UL/CUL Use Group D | 5 A |

Connection data

| | |
|--|----------------------|
| Conductor cross section solid min. | 0.13 mm ² |
| Conductor cross section solid max. | 0.34 mm ² |
| Conductor cross section stranded min. | 0.22 mm ² |
| Conductor cross section stranded max. | 0.34 mm ² |
| Conductor cross section AWG/kcmil min. | 26 |
| Conductor cross section AWG/kcmil max | 22 |
| Minimum AWG according to UL/CUL | 28 |
| Maximum AWG according to UL/CUL | 22 |

Classifications

eClass

| | |
|------------|----------|
| eCl@ss 4.0 | 27141109 |
| eCl@ss 4.1 | 27141109 |
| eCl@ss 5.0 | 27141190 |
| eCl@ss 5.1 | 27141190 |
| eCl@ss 6.0 | 27261101 |
| eCl@ss 7.0 | 27440401 |

etim

| | |
|----------|----------|
| ETIM 3.0 | EC001121 |
| ETIM 4.0 | EC002643 |
| ETIM 5.0 | EC002643 |

PCB terminal block - IDC 0,3/ 6-3,81 - 1706219

Classifications

unspsc

| | |
|---------------|----------|
| UNSPSC 6.01 | 30211801 |
| UNSPSC 7.0901 | 39121432 |
| UNSPSC 11 | 39121432 |
| UNSPSC 12.01 | 39121432 |
| UNSPSC 13.2 | 39121432 |

Approvals

Approvals

Approvals

CSA / UL Recognized / cUL Recognized / GOST / GOST / cULus Recognized

Ex Approvals

Approvals submitted

Approval details

| | | |
|---|-------|-------|
| CSA  | | |
| | B | D |
| mm ² /AWG/kcmil | 28-22 | 28-22 |
| Nominal current I _N | 5 A | 5 A |
| Nominal voltage U _N | 300 V | 300 V |

| | | |
|---|-------|-------|
| UL Recognized  | | |
| | B | D |
| mm ² /AWG/kcmil | 28-22 | 28-22 |
| Nominal current I _N | 5 A | 5 A |
| Nominal voltage U _N | 250 V | 300 V |

| | | |
|--|-------|-------|
| cUL Recognized  | | |
| | B | D |
| mm ² /AWG/kcmil | 28-22 | 28-22 |

PCB terminal block - IDC 0,3/ 6-3,81 - 1706219

Approvals

| | B | D |
|--------------------|-------|-------|
| Nominal current IN | 5 A | 5 A |
| Nominal voltage UN | 250 V | 300 V |

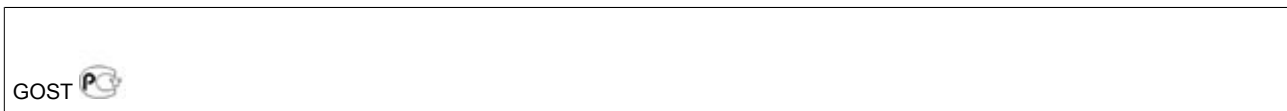

Accessories

Accessories

Marking

Marker cards - SK 3,81/2,8:FORTL.ZAHLEN - 0804109



Marker cards, Card, white, Labeled, Horizontal: Consecutive numbers 1 - 10, 11 - 20, etc. up to 91 - (99)100, Mounting type: Adhesive, For terminal block width: 3.81 mm

Drawings

Drilling diagram

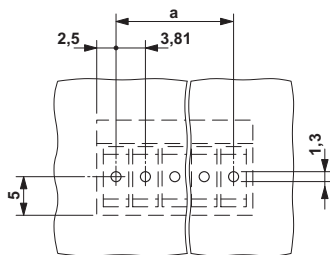

Dimensioned drawing

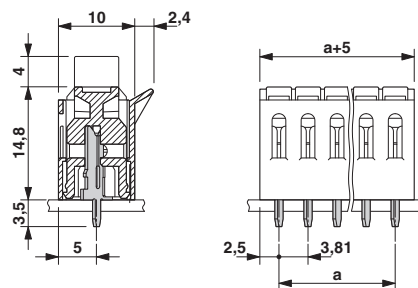

PCB terminal block - IDC 0,3/ 6-3,81 - 1706219

Diagram

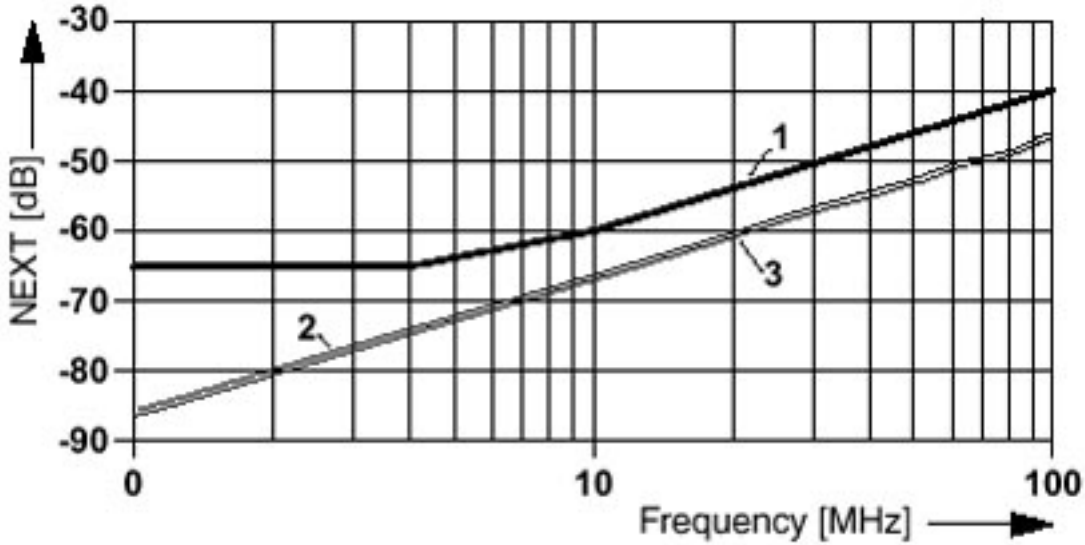

- 1 = Limit values acc. to EN 50173 for connection technology
- 2 = NEXT 12-36 on the soldering tag
- 3 = NEXT 12-36 on the contact terminal block

Diagram

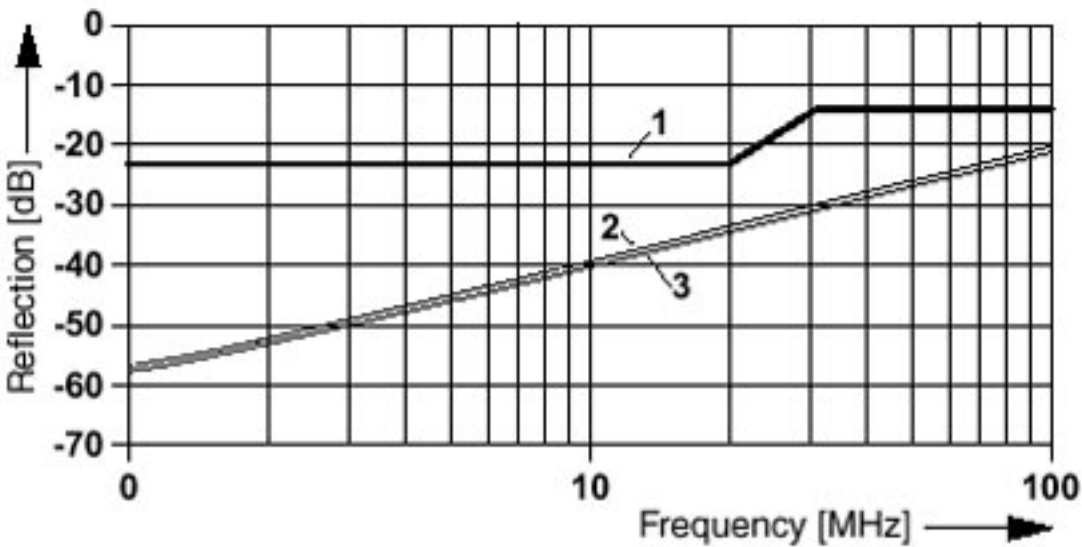

- 1 = Limit values acc. to EN 50173 for connection technology
- 2 = NEXT 12 on the soldering tag
- 3 = NEXT 36 on the soldering tag